

2

1

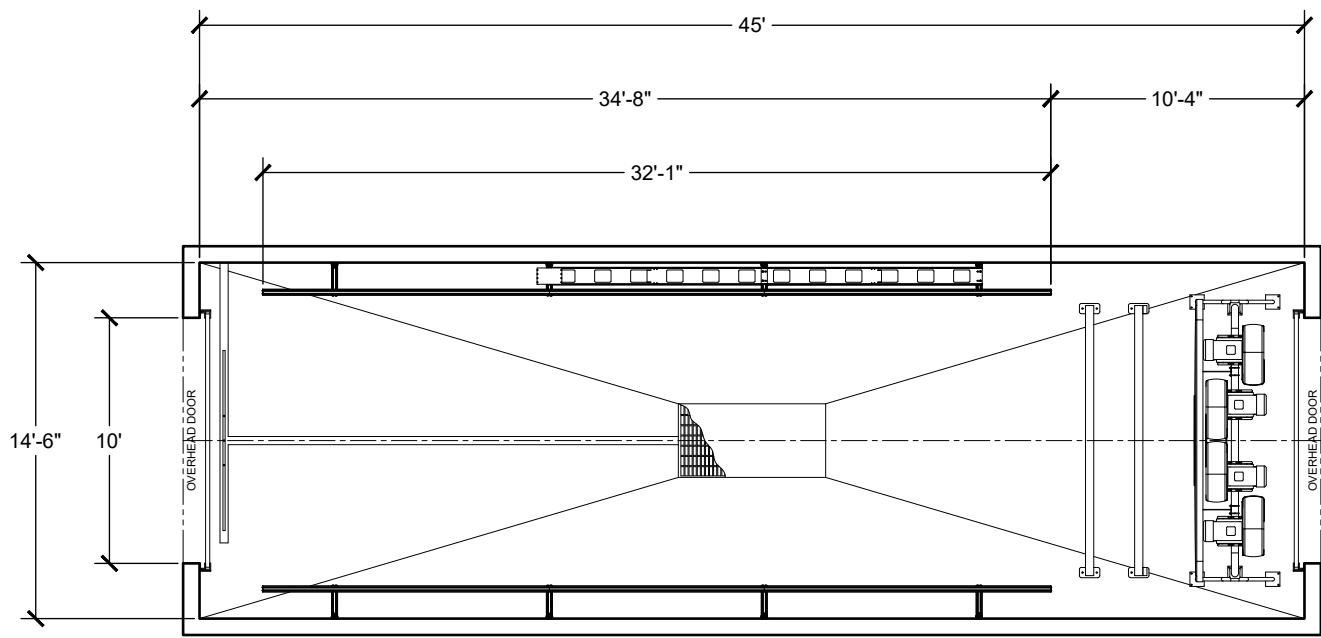
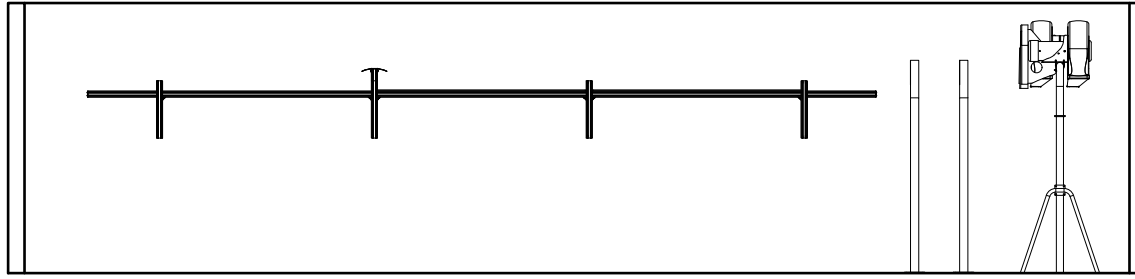

B

B

A

A



**PROPRIETARY INFORMATION**

THE INFORMATION CONTAINED IN THIS DRAWING IS THE SOLE PROPERTY OF D&S CAR WASH EQUIPMENT COMPANY. ANY REPRODUCTION IN PART OR AS A WHOLE WITHOUT THE WRITTEN PERMISSION OF D&S CAR WASH EQUIPMENT COMPANY IS PROHIBITED.

NAME	DATE
DRAWN DMM	09/28/20
ENG APPR. ---	---
MFG APPR. ---	---

UNLESS OTHERWISE SPECIFIED DIMENSIONS ARE IN INCHES

ANGLES	X	XX	XXX
± 2°	± .1	± .03	± .005

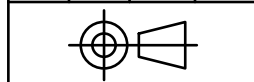

THIRD ANGLE PROJECTION

**D&S CAR WASH EQUIPMENT CO.**  
 4200 Brandi Lane • High Ridge, MO 63049  
 Voice: (636) 677-3442 • Fax: (636) 677-4105  
 www.dscarwash.com e-mail: techsupport@dscarwash.com

DESCRIPTION: **MINIMUM INSTALL  
 QUICK LOOK  
 IQSTX AR/DRY**

SIZE	DWG. NO.	PROD. REV.
A	<b>IQREF0022</b>	---

SCALE: NONE WEIGHT: XX.XLBS SHEET 01 OF 01

2

1